



RD121 ROBUST DETAILS CERTIFICATION SCHEME PLOT AMENDMENT AND CANCELLATION FORM

To be completed by the Developer. Please complete a separate form for each site.

To avoid delays with your application, please complete all applicable fields

SITE NAME

ORIGINAL ORDER REFERENCE

MAIN CONTACT DETAILS (to whom all documents will be sent by email)

Name	Company
Address	
Postcode	Telephone No
Email	
Please indicate your role: Builder <input type="checkbox"/> Developer only <input type="checkbox"/> Designer <input type="checkbox"/> Other (please specify)	

DEVELOPER OF THE SITE (the person named on the building control application)

Name	Company Name
Address	
Postcode	
Date	

BUILDING CONTROL BODY NAME

By submitting this information, you confirm that you have read, understood, and agree to the terms and conditions (available on the Robust Details website) which include obligations that you must notify the relevant building control body of all amendments and cancellations to your Plot Registration (A simple way to do this is to provide a copy of your completed amendment/cancellation form and any revised Purchase Statement relating to this application).

FEES For changes affecting:

up to 10 plots = £15 + VAT 11-20 plots = £20 + VAT 21+ plots = £30 + VAT

ORDER AND PAYMENT DETAILS

No of Plots (refer to schedule on page 3)	Amount (£) see above
Total net payment	
Please accept payment by: (please tick box) VAT@20%	
Cheque <input type="checkbox"/> Card* <input type="checkbox"/> BACS <input type="checkbox"/>	Total gross payment

BY CHEQUE:

Please make cheques payable to Robust Details Limited and attach them to this form.

*BY CARD :

We will contact you by telephone using the telephone number from the MAIN CONTACT DETAILS section of this form to collect the card details.

Data Protection Act 2018 – Data Protection Notice. This notice only applies to an individual's personal details. Robust Details Limited (RDL) is the data controller for the purposes of the Act. When you contact RDL your personal details will be recorded (or processed as the Act calls it). RDL will record your details for the purposes of dealing with your enquiries about robust details, the provision of services by RDL, administration, research and for statistical purposes. RDL may disclose your details to local and national authorities and Government Departments involved with robust details and the Building Regulations and to any warranty and insurance company providing cover on homes into which robust details are built for the purposes of its home registrations, inspections and claims handling. In the future, we may write or email you with information about our products and services. For more information please see our Privacy Policy available on our website.

If you do not wish to receive such information from us, please tick box

Robust Details Limited is a company no. 04980223 limited by guarantee, registered in England.

Robust Details Limited registered office: Unit 14, Shenley Pavilions, Chalkdell Drive, Shenley Wood, Milton Keynes MK5 6LB



RD121 AMENDMENT AND CANCELLATION FORM

To avoid delays with your application, please complete all applicable fields

CHANGING THE SITE DETAILS? Please tick appropriate box(es) below

YES <input type="checkbox"/>	NO <input type="checkbox"/>	If YES, please enter new details	Site name _____
			Site address _____ _____
			Postcode _____

CHANGING THE BUILDER DETAILS? Please tick appropriate box(es) below

YES <input type="checkbox"/>	NO <input type="checkbox"/>	If YES, please enter new details	Builder company _____
			Builder address _____ _____
			Postcode _____

CHANGING THE DEVELOPER DETAILS? Please tick appropriate box(es) below

YES <input type="checkbox"/>	NO <input type="checkbox"/>	If YES, please enter new details	Developer company _____
			Developer address _____ _____
			Postcode _____

CHANGING/CANCELLING PLOT DETAILS? Please tick appropriate box(es) below

YES <input type="checkbox"/>	NO <input type="checkbox"/>	If YES	AND	YES <input type="checkbox"/>	NO <input type="checkbox"/>
		Enter details of changes on the following schedule	Indicate whether work has started on the plots cancelled?		

INDICATE REASON FOR CANCELLATION

- Registered in error
- Design does not match an RD specification
- Building control body/verifier requested PCT
- Site replan
- Decided to use PCT option instead of RDs
- Other - please state _____

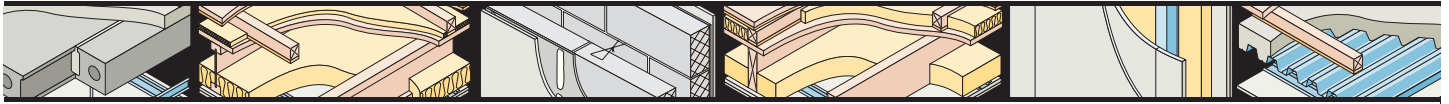

RD121 AMENDMENT AND CANCELLATION FORM

Plot amendment/cancellation schedule. For use only when amending or cancelling existing registered plots

Please note that any separating walls or floors which are not registered with Robust Details Limited may be subject to the pre-completion testing (PCT) method of satisfying the Building Regulations. In the case of flats/apartments, it is essential that you consult the tables in the introduction of the robust details handbook to identify which combinations of walls and floors are permissible, and which would be subject to pre-completion sound testing.

EXAMPLE								
Original block number/name (if applicable)	Original plot numbers	New plot numbers	Tick one box only		Quantity of Plots?	House or Flat? (H or F)	Wall RD type? e.g. E-WM-11	Floor RD Type? e.g. E-FT-1
			Cancel	Amend				
	1 - 5	N/A	✓		5	F	N/A	N/A
	60 - 62	109 - 111	N/A	✓	3	F	E-WT-1	E-FT-1
	30 - 31	30a - 31a		✓	2	H	E-WM-11	N/A

PLOT SCHEDULE (A copy of this page may be used as a continuation sheet if required)								
Original block number/name (if applicable)	Original plot numbers	New plot numbers	Tick one box only		Quantity of Plots?	House or Flat? (H or F)	Wall RD type? e.g. E-WM-11	Floor RD Type? e.g. E-FT-1
			Cancel	Amend				
Total						Carry forward to page 1 or if applicable, a continuation sheet		